

Precision – Linear – Potentiometer DL32

Standard version



The Precision - Linear - Potentiometers of the type DL32 have an anodized aluminium housing and achieve in the standard version protection class IP65. The smooth running is ensured by permaglide sliding bearings.

The standard version is supplied with 2 clamping clips.

mechanical data

- 1.1 housing..... : aluminium
- 1.2 pushrod..... : stainless steel Ø 6^{h9}
- 1.3 bearing..... : permaglide sliding bearing
- 1.4 resistor element..... : precision wire winding
- 1.5 slider / wiper tap..... : noble metal, multiple
- 1.6 housing protection class..... : IP 65
- 1.7 type of connection..... : plug connection
- 1.8 mounted by..... : clamping clips
- 1.9 functional path..... : 50...500 mm
- 1.10 rotation speed..... : 1 m / sec.
- 1.11 rotation load life..... : 1 x 10⁶ m path

electrical data

- 2.1 resistance values, standard..... : 1, 2, 5, 10 K-Ohm
- 2.2 resistance values, max. possible... : according to table
- 2.3 resistance tolerance..... : ± 3%
- 2.4 lowest starting resistance..... : 0,05% of overall resistance
- 2.5 linearity tolerance..... : ± 0,3%
- 2.6 insulation resistance..... : 20 M-Ohm
- 2.7 test voltage..... : 500 V, 50 Hz
- 2.8 operating voltage..... : max. 50 V
- 2.9 power rating..... : max. 2 Watt
- 2.10 slider load current..... : 1 mA (max., load life)
- 2.11 temperature range..... : -50°C till +100°C
- 2.12 temperature coefficient..... : 20 ppm/°C

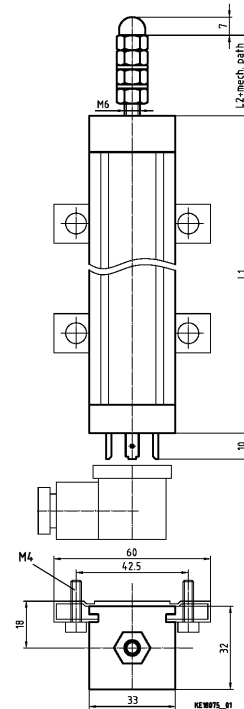

Type	Path in mm		max KΩ	L1 in mm ±2mm	
	electr. +0,8mm	mechan. ±3mm		Tfa	Rfi
DL32/ 50	50	60	40	151	226
DL32/100	100	110	80	226	251
DL32/150	150	160	120	251	301
DL32/200	200	210	160	301	376
DL32/250	250	260	200	376	426

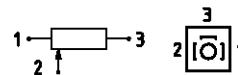

Options	L2 in mm
Construction set calliper spring outside DL32	88
Construction set return spring inside DL32	37

Terminal plan standard	
pushrod in	
1	start
2	slider
3	end

Options

- short-circuit tracks
- different functional path
- resistance tolerance: ±1%
- linearity: min. 0,1%
- pushrod: special length
- spring function

Terminal plan Tfa	
pushrod out	
1	start
2	slider
3	end

Sheet #: KE3371.DOC

Amendment / Print: 12.04.13 / 07.05.13